

SSBMPMWA363

Graphicwall beidseitig, 1 x 2,5 m
Graphicwall two-sided, 1 x 2,5 m

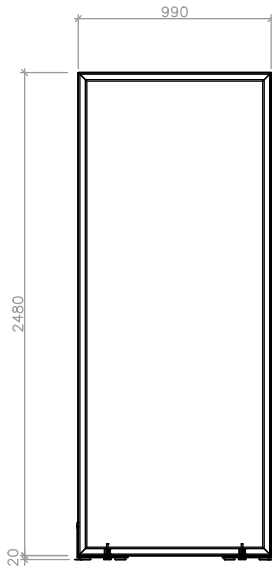

**Ansicht Front/
Front view**



GRAFIKMASSE/GRAPHIC SIZES		
	Breite/Width	Höhe/Height
G1	990 mm*	2480 mm*
G2	990 mm*	2480 mm*

* plus Beschnittzugabe umlaufend 10 mm
 * supply an addition for bleed 10 mm on all sides

B = Breite | Width
 H = Höhe | Height
 T = Tiefe | Depth

**Draufsicht/
Top view**

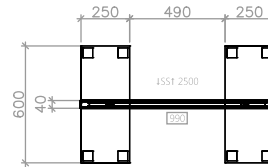

Seite/side A

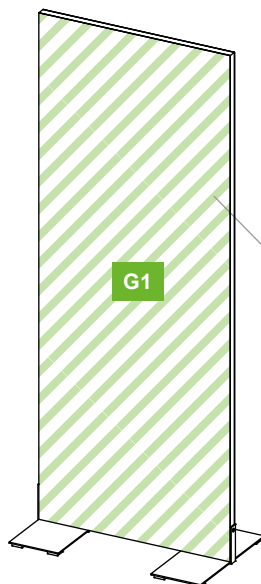

Seite/side B

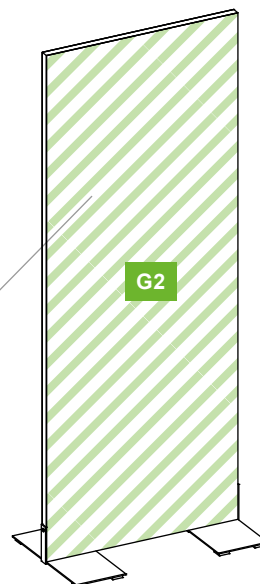

Stoff beidseitig | fabric on both sides
 Stoffmaß | fabric size
 Grafikmaß | Graphic size
 B = 990 mm, H = 2480 mm