

SSBMPA330

**Informationstheke Octanorm LED**  
**Info counter Octanorm LED**



GRAFIKMASSE/GRAPHIC SIZES		
	Breite/Width	Höhe/Height
<b>G1</b>	949 mm*	892 mm*
<b>G2</b>	455 mm*	892 mm*
<b>G3</b>	455 mm*	892 mm*

\* plus Beschnittzugabe umlaufend 10 mm  
\* supply an addition for bleed 10 mm on all sides

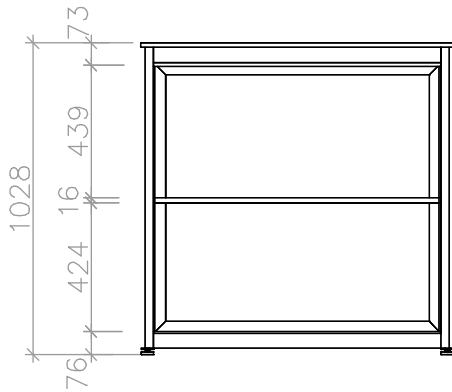

B = Breite | Width  
H = Höhe | Height  
T = Tiefe | Depth

**Draufsicht/  
Top view**

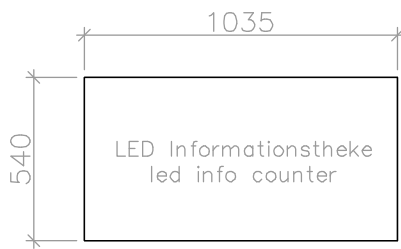

Plattenmaß | Panel size  
B = 1035 mm, T = 540 mm

Auflageplatte | top plate  
KS 16 mm

**Rückansicht/  
Back view**

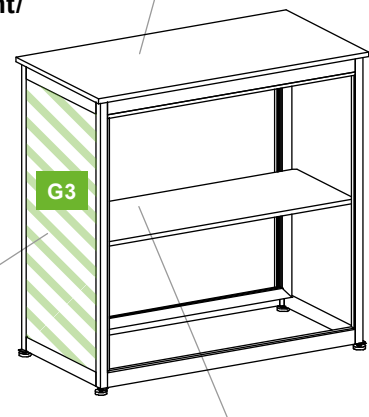

Plattenmaß | Panel size  
B = 471 mm, T = 912 mm

Grafikmaß | Graphic size  
B = 455 mm, H = 892 mm

Plattenmaß | Panel size  
B = 971 mm, T = 389 mm

Einlegeboden | Shelf  
KS 19 mm

**Ansicht Front/  
Front view**

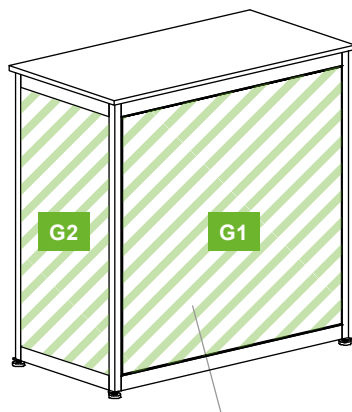

hinterleuchtet | backlit

Grafikmaß Stoff | Graphic size fabric  
B = 949 mm, H = 892 mm